

£150,000

Redwing Court, Southsea PO4 8PB

bernards
THE ESTATE AGENTS



HIGHLIGHTS

- ❖ ONE BEDROOM
- ❖ GROUND FLOOR FLAT
- ❖ AMPLE STORAGE
- ❖ MODERN FITTED KITCHEN
- ❖ EASY ACCESS SHOWER ROOM
- ❖ COMMUNAL GARDENS
- ❖ CLOSE TO LOCAL AMMENITIES
- ❖ SOUGHT AFTER LOCATION
- ❖ CLOSE TO MILTON COMMON
- ❖ CALL TO VIEW

ONE BEDROOM MODERN APARTMENT IN SOUTHSEA

Welcome to this charming ground floor flat located in Redwing Court, Southsea. This purpose-built property offers a comfortable living space of 489 square feet, making it an ideal choice for first-time buyers or investors looking to expand their portfolio.

As you enter the flat, you will find a welcoming reception room. The

well-proportioned bedroom offers a peaceful retreat, while the bathroom is conveniently located to serve both residents and visitors alike.

One of the standout features of this property is its position within a private development, ensuring a sense of security and community. Residents can also enjoy access to a lovely communal garden.

With its prime location in Southsea, this flat is well-connected to local amenities, including shops, cafes, and transport links, making it a convenient base for everyday living.

Call today to arrange a viewing
02392 864 974
www.bernardsea.co.uk





Call today to arrange a viewing
02392 864 974
www.bernardsestates.co.uk



PROPERTY INFORMATION

Anti-Money Laundering (AML)

Bernards Estate agents have a legal obligation to complete anti-money laundering checks. The AML check should be completed in branch. Please call the office to book an AML check if you would like to make an offer on this property. Please note the AML check includes taking a copy of the two forms of identification for each purchaser. A proof of address and proof of name document is required. Please note we cannot put forward an offer without the AML check being completed

Bernards Mortgage & Protection

We have a team of advisors covering all our offices, offering a comprehensive range of mortgages from across the market and various protection products from a panel of lending insurers. Our fee is competitively priced, and we can help advise and arrange mortgages and protection for anyone, regardless of who they are buying and selling through.

If you're looking for advice on borrowing power, what interest rates you are eligible for, submitting an agreement in principle, placing the full mortgage application, and ways to protect your health, home, and income, look no further!

Council Tax Band - B

Leasehold Information

Management Company : Portsmouth City Council
Lease Length : Ground Rent : £10 Service Charge : £841.91

Please note that Bernard's Estate Agents have not checked or verified the lease terms or the service charge/ground rent costs. The information provided above has been provided to us from the Seller. Your solicitor will check all of the above during the conveyancing process and you should only rely on information provided by them when making the final decision as to whether to buy any leasehold property.

Offer Check Procedure -

If you are considering making an offer for this or any other property we are marketing, please make early contact with your local office to enable us to verify your buying position. Our Sellers expect us to report on a Buyer's proceedability whenever we submit an offer. Thank you.

Property Tenure

Leasehold

Removal Quotes

As part of our drive to assist clients with all aspects of the moving process, we have sourced a reputable removal company. Please ask a member of our sales team for further details and a quotation.

Solicitor

Choosing the right conveyancing solicitor is extremely important to ensure that you obtain an effective yet cost-efficient solution. The lure of supposedly cheaper on-line "conveyancing warehouse" style services can be very difficult to ignore but this is a route fraught with problems that we strongly urge you to avoid. A local, established and experienced conveyancer will safeguard your interests and get the job done in a timely manner. Bernards can recommend several local firms of solicitors who have the necessary local knowledge and will provide a personable service. Please ask a member of our sales team for further details.

Lounge/Diner

11'6" x 16'6" (3.51 x 5.04)

Bedroom

10'6" x 12'7" (3.21 x 3.86)

Bathroom

5'6" x 7'10" (1.68 x 2.39)

Kitchen

8'10" x 7'10" (2.70 x 2.41)



Energy Efficiency Rating		Current	Potential
Very energy efficient - lower running costs			
(92 plus)	A		
(81-91)	B		
(69-80)	C		
(55-68)	D		
(39-54)	E		
(21-38)	F		
(1-20)	G		
		52	72
Not energy efficient - higher running costs			
England & Wales		EU Directive 2002/91/EC	



GROUND FLOOR
489 sq.ft. (45.4 sq.m.) approx.

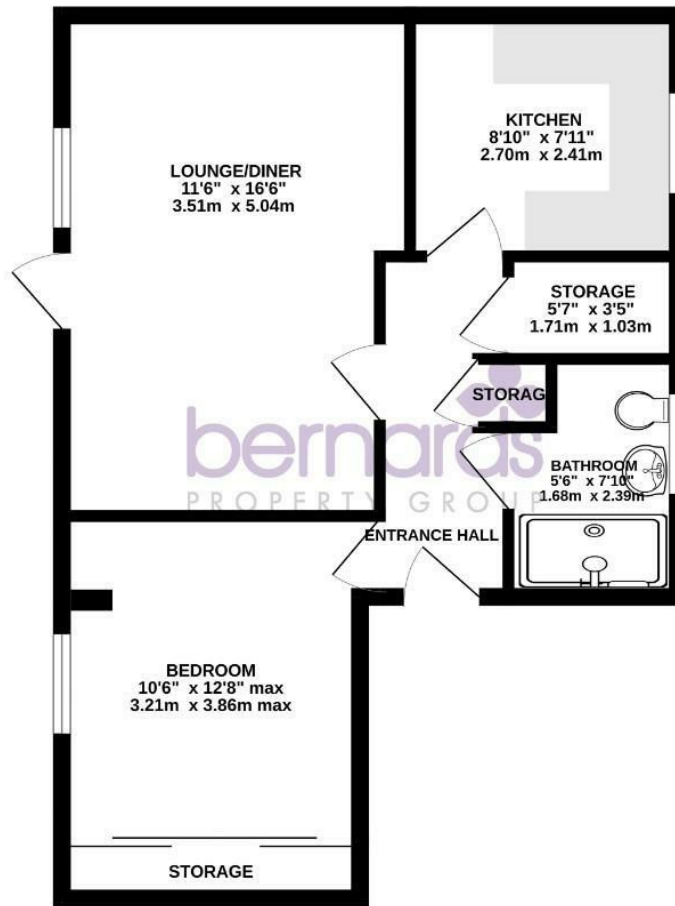

TOTAL FLOOR AREA: 489 sq.ft. (45.4 sq.m.) approx.

Whilst every attempt has been made to ensure the accuracy of the floorplan contained here, measurements of doors, windows, rooms and any other items are approximate and no responsibility is taken for any error, omission or mis-statement. This plan is for illustrative purposes only and should be used as such by any prospective purchaser. The services, systems and appliances shown have not been tested and no guarantee as to their operability or efficiency can be given.
Made with Memphis ©2025

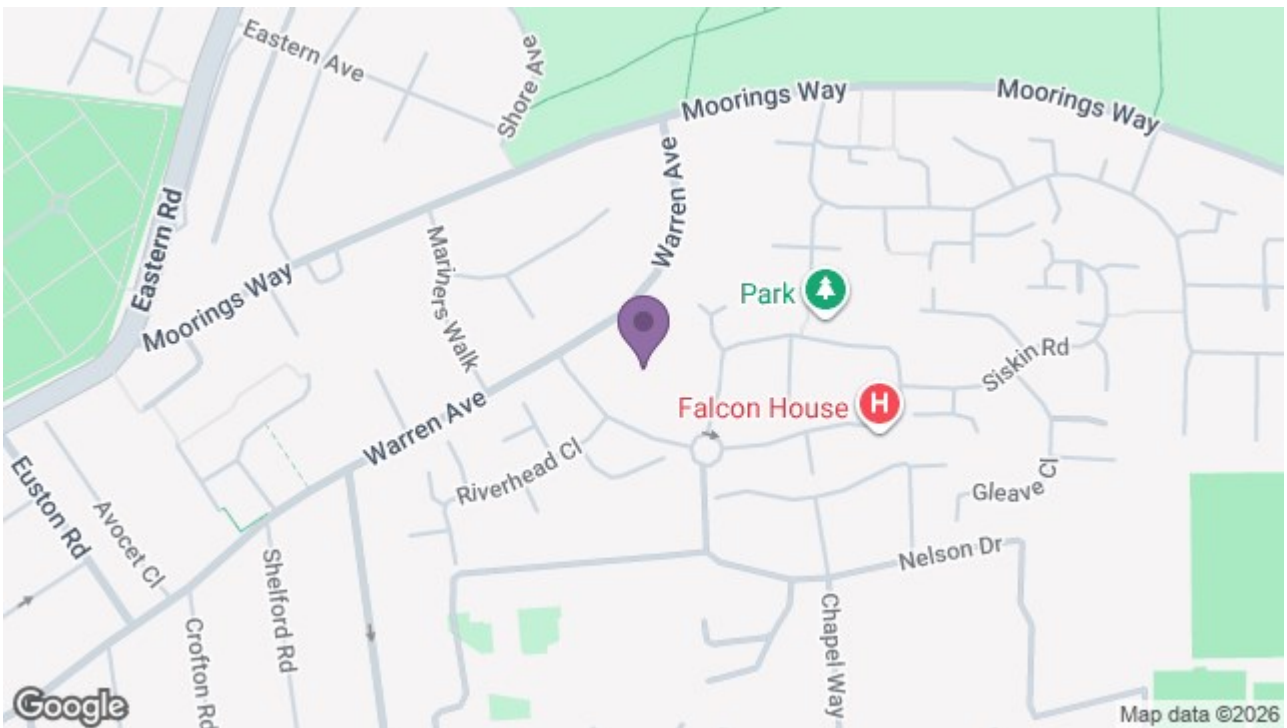

8 Clarendon Road, Southsea, Hampshire, PO5 2EE
t: 02392 864 974

